



ALPHA
Elevator & Engineering Ltd.
Elevating Lives, Building Futures



WELCOME TO ALPHA ELEVATOR

Your Trusted Partner in Vertical Transportation

At Alpha Elevator, we are dedicated to revolutionizing the way people move, bringing innovation and excellence to every aspect of vertical transportation. With cutting-edge technology, exceptional craftsmanship, and an unwavering commitment to safety, we design, manufacture, install, and maintain elevators that set new benchmarks in reliability, efficiency, and performance. Our team combines years of expertise with forward-thinking solutions, ensuring that our products meet the highest industry standards and exceed customer expectations.

From the latest in smart elevator systems to custom-designed installations for unique building needs, we offer tailored solutions that enhance user experience, optimize energy consumption, and improve operational efficiency. Our focus on precision engineering ensures smooth, safe, and quiet rides for passengers, while our maintenance programs guarantee long-term performance and reliability.

Driven by our core values of quality, innovation, and sustainability, we strive to make a positive impact on the spaces we serve. Whether it's a residential high-rise, a commercial skyscraper, or a specialized facility, our elevators are built to perform seamlessly in every setting. Our mission is embodied in our tagline: "Elevating Lives, Building Futures," reflecting our passion for shaping a better, more connected future through safe and efficient mobility solutions. At Alpha Elevator, we don't just move people; we elevate their experiences, empowering communities, and transforming buildings for generations to come.

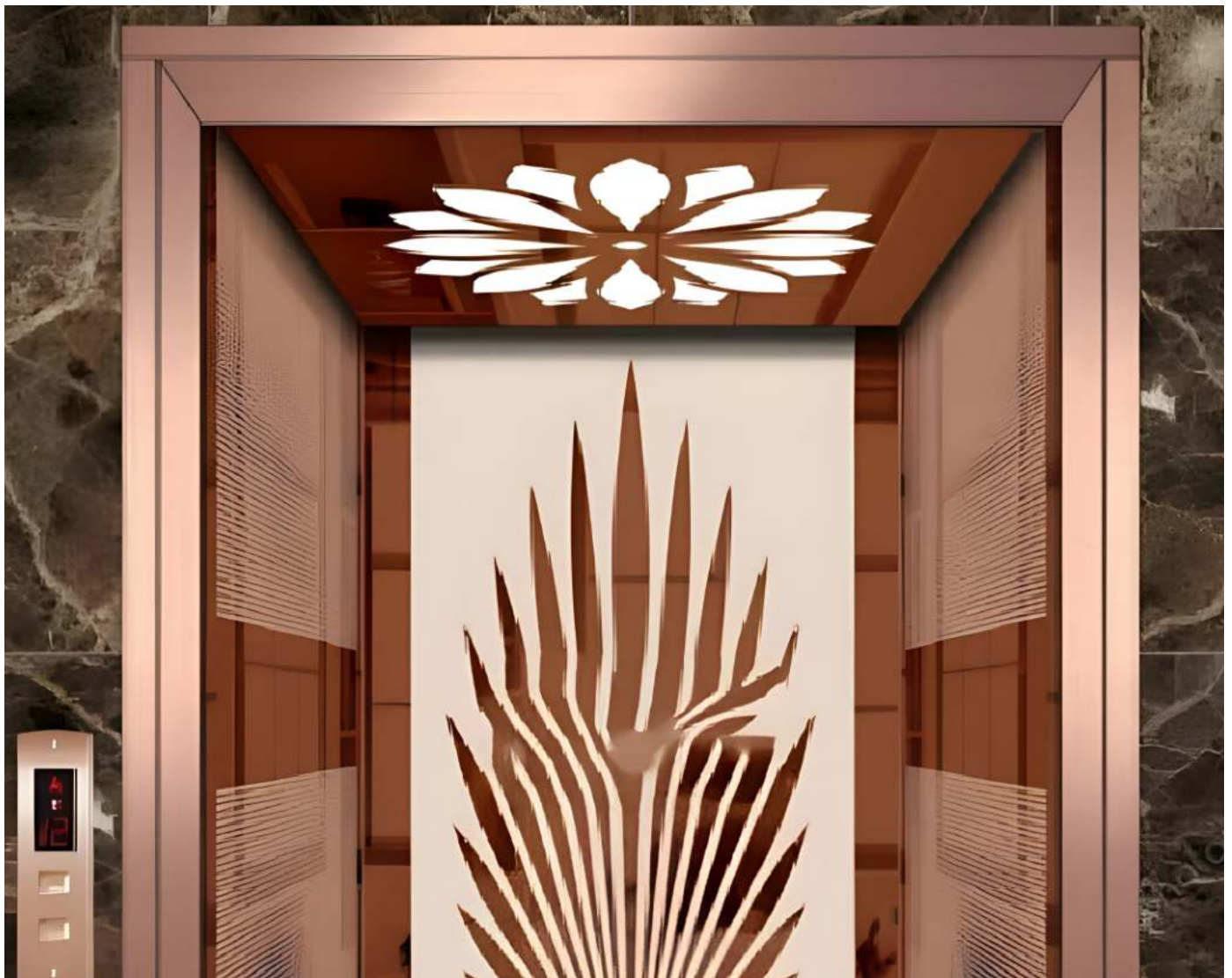

WHY CHOOSE ALPHA ELEVATOR?

01: Innovation at Its Core

We stay ahead of the curve by leveraging the latest advancements in elevator technology. From energy-efficient systems to smart features, our solutions are designed to meet the demands of modern urban living.



02: Unmatched Safety Standards

Your safety is our priority. Every Alpha Elevator is built to comply with global safety standards, ensuring smooth and secure operation.

03: Customer-Centric Approach

Our team works closely with clients to deliver tailor-made solutions that suit their specific needs, whether it's a high-rise commercial building or a residential property. We deliver state-of-the-art elevator solutions that redefine safety and efficiency.



INNOVATIVE PRODUCTS

We create innovative solutions that ensure every passenger in every building remains seamlessly in motion, regardless of the environment. Our products are meticulously designed with a strong emphasis on enhancing mobility, accessibility, and user experience, offering smooth, reliable, and efficient transportation in a wide variety of spaces. From state-of-the-art elevator cabins that prioritize comfort, safety, and aesthetics, to advanced control systems that not only optimize performance but also drive energy efficiency and sustainability, our offerings are tailored to meet the evolving demands of modern architecture and the built environment.

With cutting-edge technology and forward-thinking design, we provide adaptable solutions for both high-rise buildings and low-rise structures, catering to residential, commercial, and industrial applications. Our solutions are built to offer enhanced user experiences, from faster travel times to greater reliability and ease of use. Above all, we hold a deep commitment to quality, innovation, and continuous improvement. Our goal is to set new industry standards, pushing the boundaries of vertical transportation and shaping the future of mobility for years to come, ensuring that passengers can move efficiently, safely, and comfortably, wherever they are.



INDUSTRIES WE SERVE

- Government Projects
- Commercial Complexes
- Hospitality and Hotels
- Educational Institutions
- Industrial Plants
- Retail Spaces
- Healthcare Facilities
- Residential Buildings

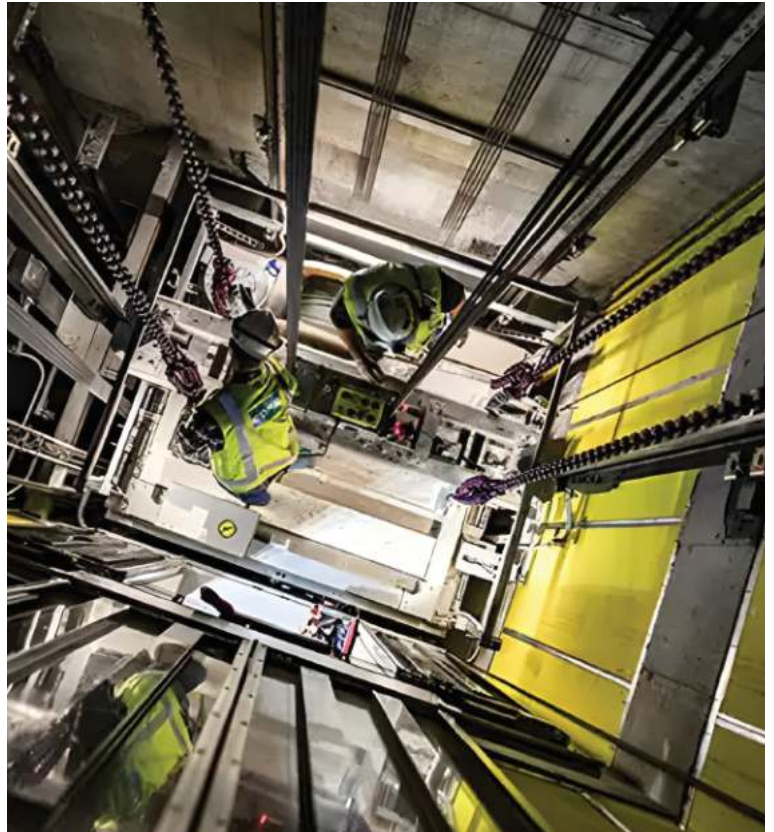

TECHNICAL STRENGTH

▼ Effective, speedy and High-End Intellectual Design

It gives first priority to effectiveness in vertical transport field. In order to the service efficiency of the elevator system, ALPHA elevator fulfills the ctual managements such as multi-computer, modular and network control etc, through fully computerized intellectual control system.

It instantly feeds back the elevator running conditions. It provides the passengers with the most efficient gold-collar services.

▼ Serial Communication Technology

It adopts the network communication, which brings great reduction of the wires, enhancement of the reliability and less installation period.

▼ Microcomputer Group Supervision Management System

Duty on/off rush-hour running mode:it satisfies the running requirements in the rush hours of duty on/off the public occasions in the office building and etc.

Even operation mode: It adopts the minimized waiting period distribution principle with the prompt and reasonable elevator response.

Idle running mode: The elevators have been evenly distributed in the designated area to wait far call in indle times in order to guarantee the quick and timely response towards the outer balls.

▼ Remote Control System Ensures Intelligent Supervision

Through wire or wireless communication, the operation status and success situation of passengers in elev protected in remote control center. Malfunctions are excluded before occurrence and nip them in the bud to ensure the safty of passengers.





▼ Mute Braking Control Technology

- ✓ Compared with the traditional voltage open-loop control.
- ✓ It applies the more accurate current closed-loop control mode.
- ✓ It controls various steps of action speed and braking torque of the brake.
- ✓ It greatly reduces noise in brake action.
- ✓ It enhances the comfortable travel.

▼ Top Advanced Door Operator System

The door operator control system of ALPHA elevator applies dual control system. One group is controlled by main controller of control cabinet.

The other one is by door operator controller, which greatly reduces non-opening accidents due to trouble of door machine control.



Green
environmental
protection



Effective and
energy-saving



Low noise



OUR SERVICES



SMALL MACHINE ROOM ELEVATOR



▼ It Fulfills Small Cost

Small volume traction machine combines with integrated controller, so that it makes the machine room size same with well size. It covers the equal area as that of the well. At the same time of reducing the machine room height it beautifies the building outlook. It fulfills super small standard of machine room space and building cost.

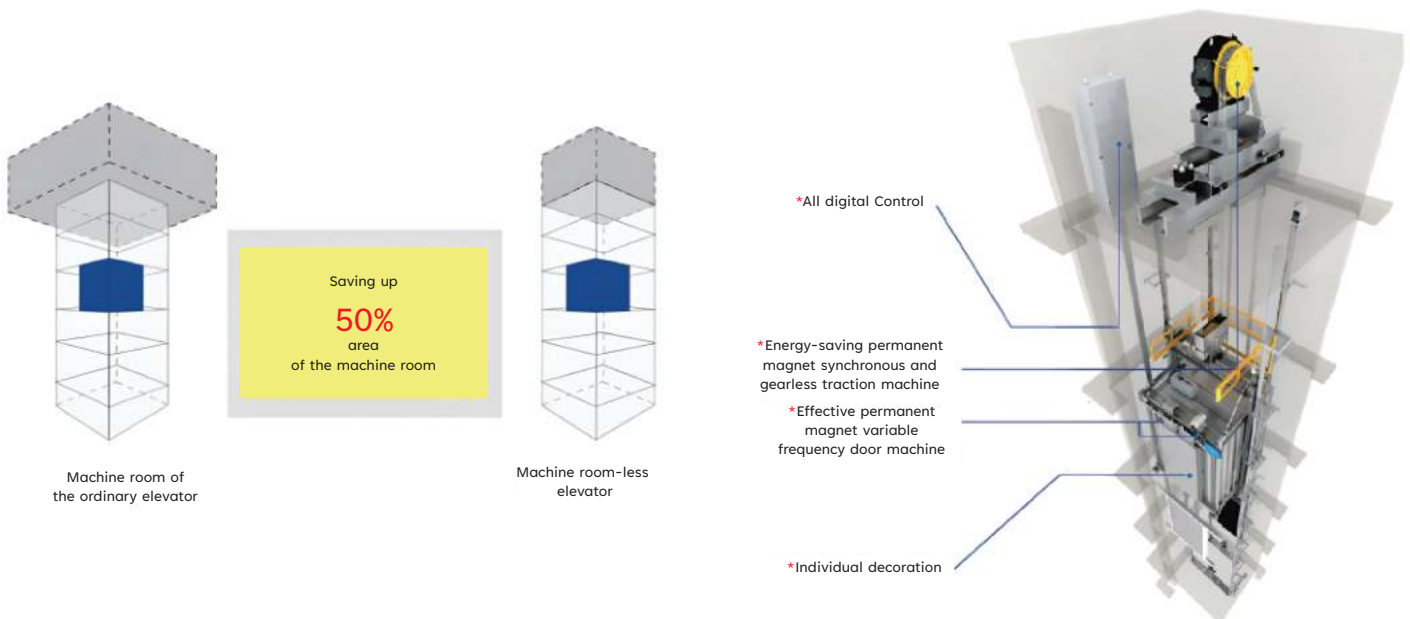

Small Machine Room Elevator Construction Sketch

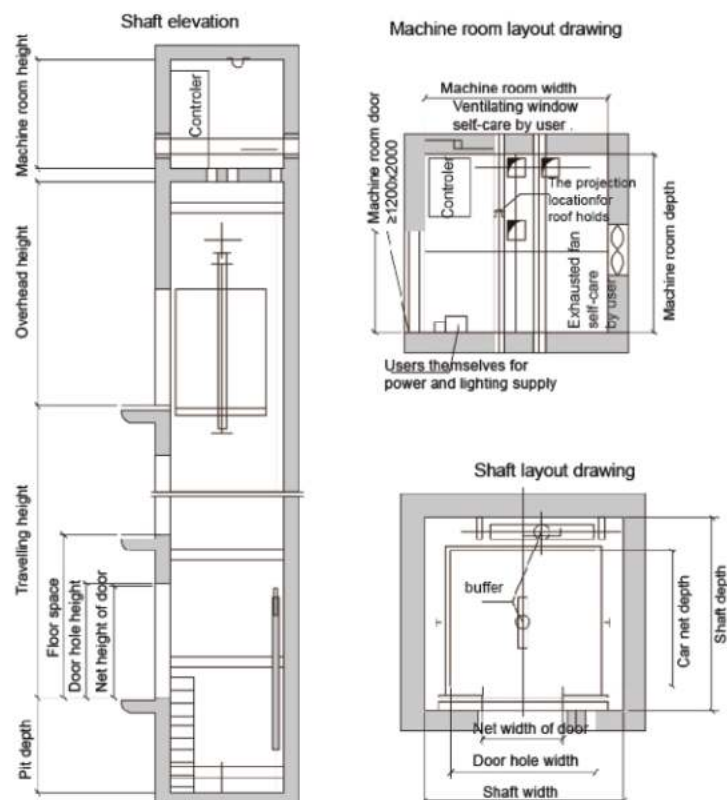

Small machine room elevator parameter table

| Persons | Load (kg) | Speed (m/s) | Net size of car(mm) | Net size of door(mm) D.WxD.H | Shaft size(mm) | | | Machine room size(mm) | |
|---------|-----------|-------------|---|---------------------------------|---|------|------|---|------|
| | | | C.WxC.DxD.H | 2P Central opening | H.WxD.H | HR.H | PIT | MR.WxMR.D | MR.H |
| 6 | 450 | 1.0 | 1400*850*2300 | 800*2100 | 2000*1500 | 4000 | 1500 | 2000*1500 | 2500 |
| | | 1.5/1.75 | | | | 4400 | | | |
| 8 | 630 | 1.0 | 1400*1100*2300 | 800*2100 | 2000*1720 | 4200 | 1500 | 2000*1720 | 2500 |
| | | 1.5/1.75 | | | | 4400 | 1600 | | |
| 10 | 800 | 1.0 | 1400*1350*2300 | 800*2100 | 2000*1970 | 4200 | 1500 | 2000*1970 | 2500 |
| | | 1.5/1.75 | | | | 4400 | 1600 | | |
| | | 2.0 | | | | 4800 | 1800 | | |
| | | 2.5 | | | | 5000 | 2000 | | |
| | | 4.0 | | | | 6000 | 3850 | | |
| 13 | 1000 | 1.0 | 1600*1450*2300 1100*2100*2300 (Residence/strentcher elevator) | 900*2100 | 2200*2120 2100*2500 (Residence/strentcher elevator) | 4200 | 1500 | 2200*2120 2100*2500 (Residence/strentcher elevator) | 2500 |
| | | 1.5/1.75 | | | | 4400 | 1600 | | |
| | | 2.0 | | | | 4800 | 1800 | | |
| | | 2.5 | | | | 5000 | 2000 | | |
| | | 3.0 | | | | 5200 | 2600 | | |
| | | 3.5 | | | | 5500 | 3100 | | |
| | | 4.0 | | | | 6000 | 3850 | | |
| | | 6.0 | | | | 6350 | 4300 | | |
| 16 | 1250 | 1.0 | 1900*1450*2300 | 1100*2100 | 2500*2150 | 4200 | 1500 | 2500*2150 | 2500 |
| | | 1.5/1.75 | | | | 4400 | 1600 | | |
| | | 2.0 | | | | 4800 | 1800 | | |
| | | 2.5 | | | | 5000 | 2000 | | |
| | | 3.0 | | | | 5200 | 2600 | | |
| | | 3.5 | | | | 5500 | 3100 | | |
| 18 | 1350 | 1.0 | 1900*1550*2300 | 1100*2100 | 2500*2250 | 4200 | 1500 | 2500*2250 | 2500 |
| | | 1.5/1.75 | | | | 4500 | 1600 | | |
| | | 2.0 | | | | 4800 | 1800 | | |
| | | 2.5 | | | | 5000 | 2000 | | |
| | | 3.0 | | | | 5200 | 2600 | | |
| | | 3.5 | | | | 5500 | 3100 | | |
| 21 | 1600 | 1.0 | 1900*1800*2300 | 1100*2100 | 2500*2500 | 4200 | 1500 | 2500*2500 | 2500 |
| | | 1.5/1.75 | | | | 4500 | 1600 | | |
| | | 2.0 | | | | 4800 | 1800 | | |
| | | 2.5 | | | | 5000 | 2000 | | |
| | | 3.0 | | | | 5200 | 2600 | | |
| | | 3.5 | | | | 5500 | 3100 | | |
| | | 4.0 | | | | 6000 | 3850 | | |
| | | 6.0 | | | | 6350 | 4300 | | |
| 26 | 2000 | 1.0 | 1900*2200*2300 | 1100*2100 | 2700*2700 | 4500 | 1500 | 2700*2700 | 2500 |
| | | 1.5/1.75 | | | | 4700 | 1600 | | |
| | | 2.0 | | | | 5000 | 1800 | | |

MACHINE ROOM-LESS ELEVATOR



▼ Greatness in Trivialness Intellectual and Outstanding

ALPHA's machine room-less elevator series resolves the restriction to the elevator in the construction, building cost, building design style, use range. At the same time of saving the space and cost, it provides the passengers with upper level intellectual, effective and stable travel.

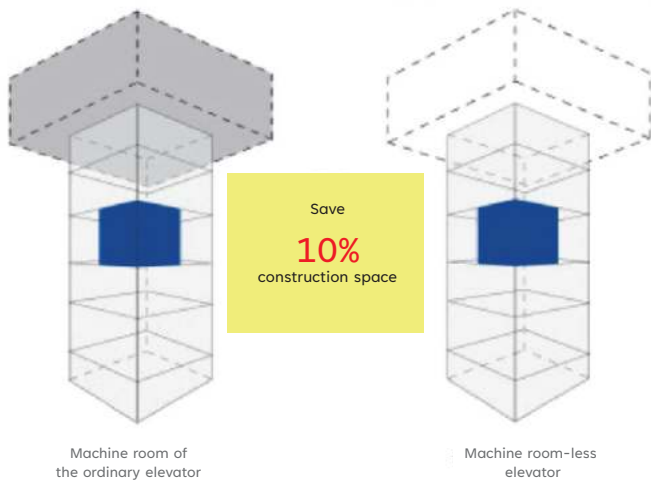

- *Well optimal design has effectively save 10% construction areas.
- *Being equipped with green drive and energy conservation device, energy conservation has reached 30%.
- *Machine roomless concept makes the design of building more free and comfortable.



Machine Room-less Elevator Construction Sketch

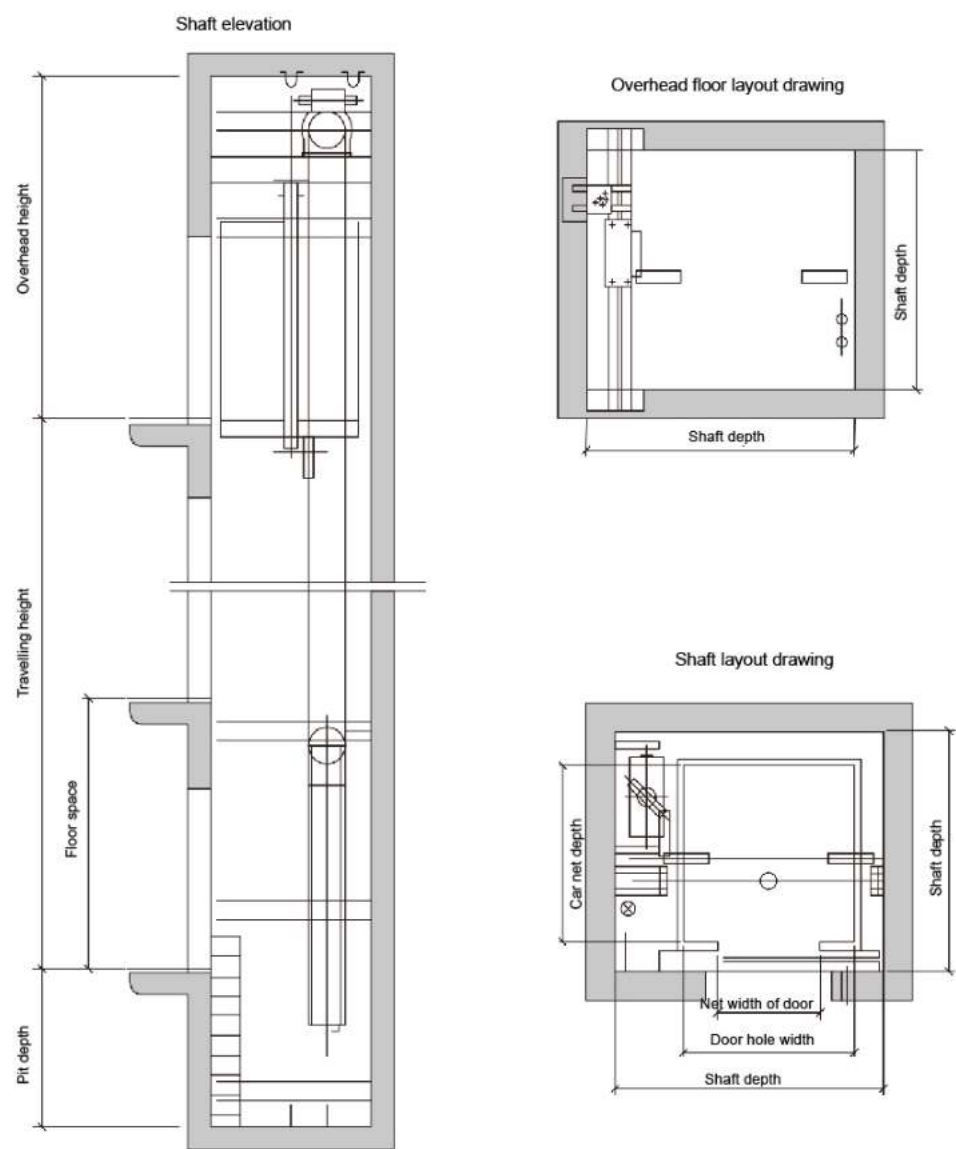

Machine room-less elevator parameter table

| Persons | Load (kg) | Speed (m/s) | Net size of car(mm) | Net size of door(mm) | Shaft size(mm) | | |
|---------|-----------|-------------|---------------------|----------------------|----------------|------|------|
| | | | C.WxC.DxD.H | 2P Central opening | H.WxH.D | HR.H | PIT |
| 6 | 450 | 1.0 | 1100*1100*2300 | 800*2100 | 2050*1850 | 4200 | 1500 |
| 8 | 630 | 1.0 | 1400*1100*2300 | 800*2100 | 2250*1900 | 4200 | 1500 |
| | | 1.5/1.75 | | | | 4400 | 1600 |
| 10 | 800 | 1.0 | 1400*1350*2300 | 800*2100 | 2250*1950 | 4200 | 1500 |
| | | 1.5/1.75 | | | | 4400 | 1600 |
| | | 2.0 | | | | 4800 | 1800 |
| | | 2.5 | | | | | 2000 |
| | | | | | | | |
| 13 | 1000 | 1.0 | 1500*1550*2300 | 900*2100 | 2350*2150 | 4200 | 1500 |
| | | 1.5/1.75 | | | | 4400 | 1600 |
| | | 2.0 | | | | 4800 | 1800 |
| | | 2.5 | | | | 4800 | 2000 |
| | | | | | | | |
| 21 | 1600 | 1.0 | 1900*1800*2300 | 1100*2100 | 2850*2400 | 4500 | 1500 |
| | | 1.5/1.75 | | | | 4700 | 1600 |
| | | 2.0 | | | | 4900 | 1800 |
| | | 2.5 | | | | 5100 | 2000 |
| | | | | | | | |
| 26 | 2000 | 1.0 | 1900*2200*2300 | 1100*2100 | 2900*2600 | 4500 | 1500 |
| | | 1.5/1.75 | | | | 4700 | 1600 |
| | | 2.0 | | | | 4900 | 1800 |

SQUARE OBSERVATION ELEVATOR



▼ Superior Car Wall

It adopt highly secure safety laminated glass. It is transparent. The passengers might appreciate the busy and prosperous city sight through the transparent car wall. Lamination layer in limited glass resists radiation. It buffers sound-wave vibration and isolates the sound. Large area car wall glass design shows smooth and beautiful lines. It beautifies the elevator car outline. Furthermore, the buildings are attractive.

▼ Super large viewing field

Full transparent lift car design can maximize the field of view. Through the visual extension, passengers can have a panoramic view of all the beautiful scenery.

▼ Multiple lift car shapes

Round, square and rhombic and other lift car shapes are optional, perfectly corresponding to different architectural styles.



Square Observation Elevator Construction Sketch

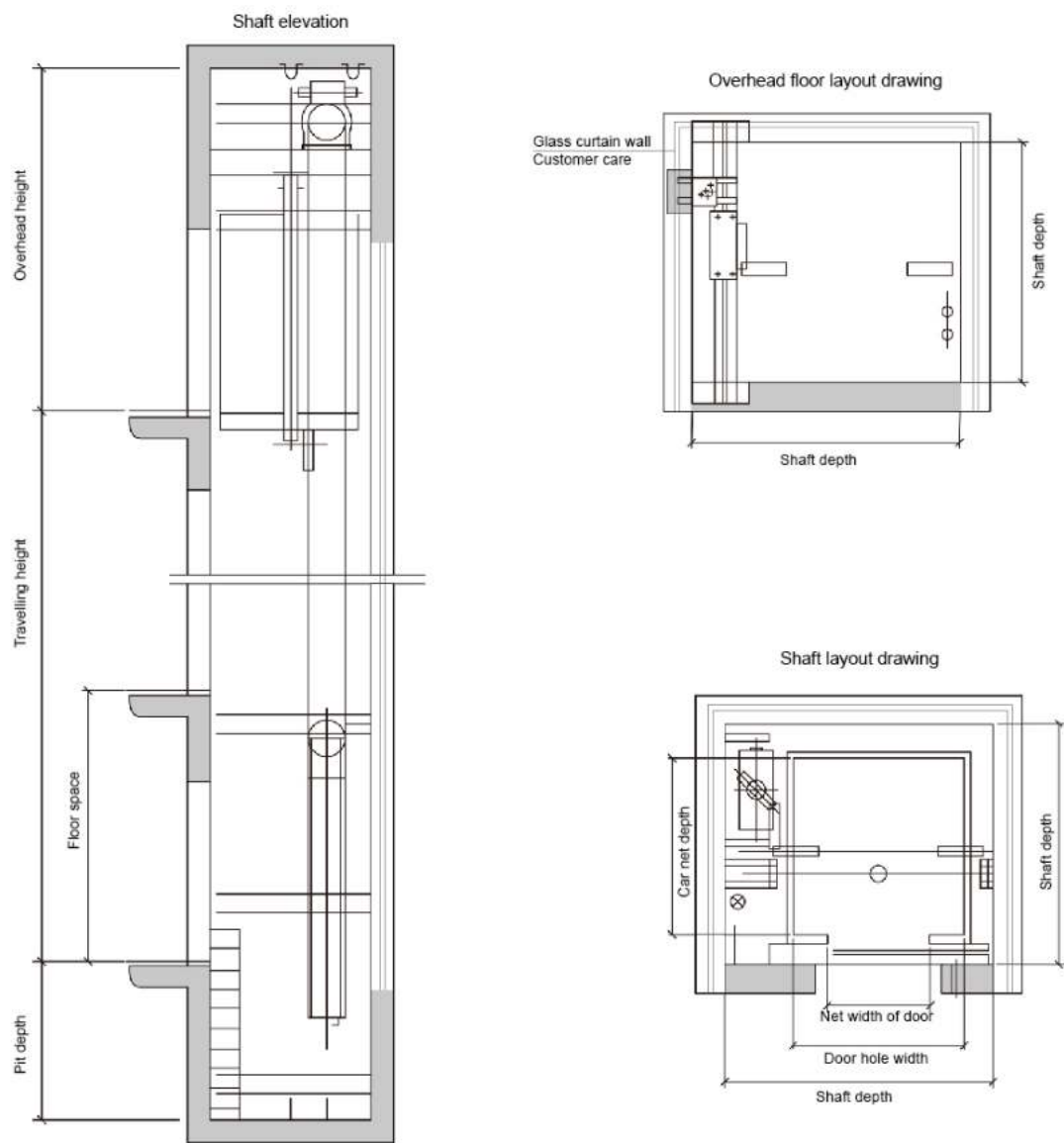

Square machine room/machine roomless elevator parameter table

| Persons | Load (kg) | Speed (m/s) | Net size of car(mm) | Net size of door(mm) D.WxD.H | Shaft size(mm) | | |
|---------|--------------|----------------|---------------------|---------------------------------|----------------|------|------|
| | | | C.WxC.DxD.H | 2P Central opening | H.WxH.D | HR.H | PIT |
| 6 | 450 | 1.0 | 1100*1100*2300 | 800*2100 | 2050*1850 | 4200 | 1500 |
| 8 | 630 | 1.0 | 1400*1100*2300 | 800*2100 | 2250*1900 | 4200 | 1500 |
| | | 1.5/1.75 | | | | 4400 | 1600 |
| 10 | 800 | 1.0 | 1400*1350*2300 | 800*2100 | 2250*1950 | 4200 | 1500 |
| | | 1.5/1.75 | | | | 4400 | 1600 |
| | | 2.0 | | | | 4800 | 1800 |
| | | 2.5 | | | | 4800 | 2000 |
| 13 | 1000 | 1.0 | 1500*1550*2300 | 900*2100 | 2350*2150 | 4200 | 1500 |
| | | 1.5/1.75 | | | | 4400 | 1600 |
| | | 2.0 | | | | 4800 | 1800 |
| | | 2.5 | | | | 4800 | 2000 |
| 21 | 1600 | 1.0 | 1900*1800*2300 | 1100*2100 | 2850*2400 | 4500 | 1500 |
| | | 1.5/1.75 | | | | 4700 | 1600 |
| | | 2.0 | | | | 4900 | 1800 |
| | | 2.5 | | | | 5100 | 2000 |
| 26 | 2000 | 1.0 | 1900*2200*2300 | 1100*2100 | 2900*2600 | 4500 | 1500 |
| | | 1.5/1.75 | | | | 4700 | 1600 |
| | | 2.0 | | | | 4900 | 1800 |

SEMICIRCLE OBSERVATION ELEVATOR



Outer Glass Hood

It harmoniously combines with the building and surroundingd. Panoramic elevator is part of the building. It also adds a mobile charming scene for the building.

Outstanding sound insulation

The structure of the lift car is further optimized, which facilitates the elevator to achieve excellent scund insulation effect and customers to have quiet and steady using experience.

Diversified decoration design

There are a series of optional materials and colors for hoistway doors, handles and lift car walls, thus truly realizing individualized customized serives.



Semicircle Observation Elevator Construction Sketch

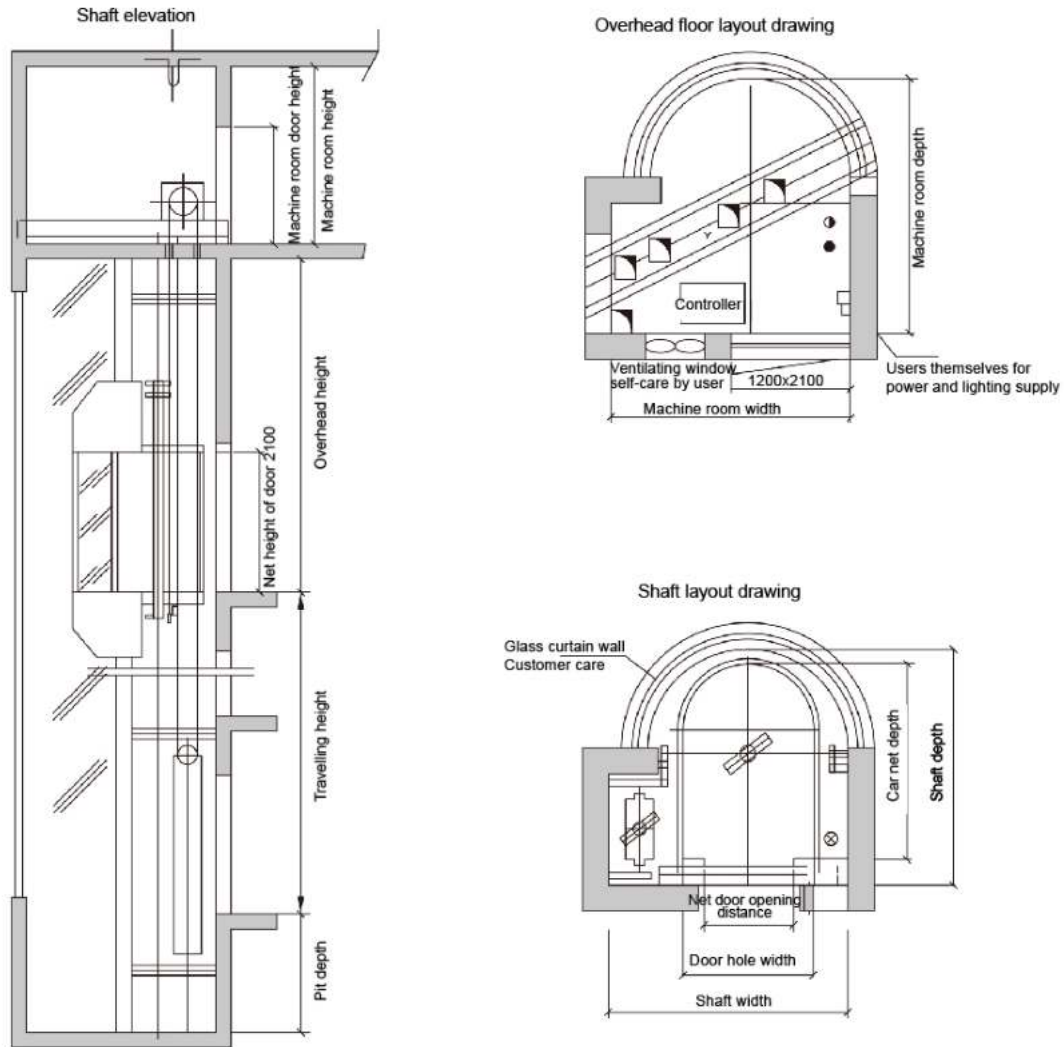

Semicircle machine room/machine roomless elevator parameter table

| Persons | Load (kg) | Speed (m/s) | Net size of car(mm) | Net size of door(mm) | Shaft size(mm) | | | Machine room size(mm) | |
|---------|--------------|----------------|---------------------|----------------------|----------------|------|------|-----------------------|------|
| | | | C.WxC.DxD.H | 2P Central opening | H.WxH.D | HR.H | PIT | MR.WxMR.D | MR.H |
| 8 | 630 | 1.0 | 1100*1600*2300 | 700*2100 | 2200*2185 | 4500 | 1500 | 2200*2185 | 2500 |
| | | 1.5/1.75 | | | | 4700 | 1600 | | |
| 10 | 800 | 1.0 | 1200*1800*2300 | 800*2100 | 2300*2355 | 4500 | 1500 | 2300*2355 | 2500 |
| | | 1.5/1.75 | | | | 4700 | 1600 | | |
| | | 2.0 | | | | 4900 | 1800 | | |
| | | 2.5 | | | | 5100 | 2000 | | |
| 13 | 1000 | 1.0 | 1300*1950*2300 | 900*2100 | 2400*2535 | 4500 | 1500 | 2400*2535 | 2500 |
| | | 1.5/1.75 | | | | 4700 | 1600 | | |
| | | 2.0 | | | | 4900 | 1800 | | |
| | | 2.5 | | | | 5100 | 2000 | | |
| 16 | 1250 | 1.0 | 1400*2150*2300 | 900*2100 | 2500*2600 | 4500 | 1500 | 2500*2600 | 2500 |
| | | 1.5/1.75 | | | | 4700 | 1600 | | |
| | | 2.0 | | | | 4900 | 1800 | | |
| | | 2.5 | | | | 5100 | 2000 | | |
| 18 | 1350 | 1.0 | 1500*2150*2300 | 1000*2100 | 2600*2600 | 4500 | 1500 | 2600*2600 | 2500 |
| | | 1.5/1.75 | | | | 4700 | 1600 | | |
| | | 2.0 | | | | 4900 | 1800 | | |
| | | 2.5 | | | | 5100 | 2000 | | |
| 21 | 1600 | 1.0 | 1500*2450*2300 | 1000*2100 | 2600*2900 | 4500 | 1500 | 2600*2900 | 2500 |
| | | 1.5/1.75 | | | | 4700 | 1600 | | |
| | | 2.0 | | | | 4900 | 1800 | | |
| | | 2.5 | | | | 5100 | 2000 | | |
| 26 | 2000 | 1.0 | 1700*2600*2300 | 1100*2100 | 2800*3050 | 4500 | 1500 | 2800*3050 | 2500 |
| | | 1.5/1.75 | | | | 4700 | 1600 | | |
| | | 2.0 | | | | 4900 | 1800 | | |

HOSPITAL ELEVATOR



▼ Warm Concern A Beautiful Humanity World

ALPHA hospital elevators are not just used in delivering passengers. Because of its use particularity, it has special and strict requirements to the elevator use properties. ALPHA hospital elevator can accurately control the elevators' running speed. It brings about the smooth and comfortable travel.

ALPHA hospital elevator lays special importance upon the humane design. It fully optimizes the car structure. It satisfies the clients' use requirements to the greatest extent. It creates a peaceful and graceful space for vast passengers.

Alpha hospital elevator satisfies the needs of emergency patients' delivery. It applies humanization design and is equipped with a full set of top equipments. It is smooth and comfortable in running.

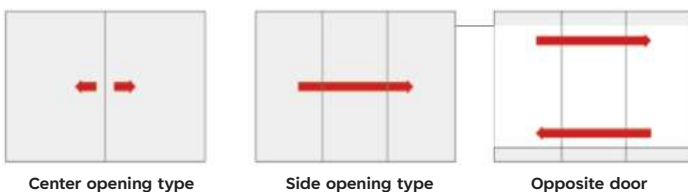

Hospital Elevator Construction Sketch

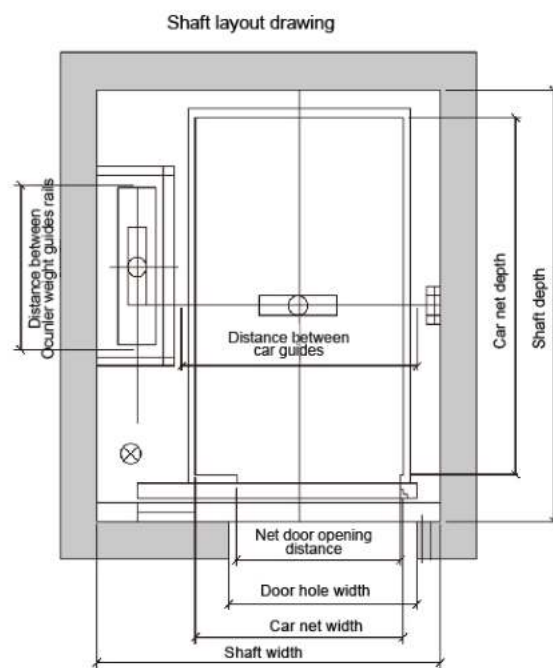
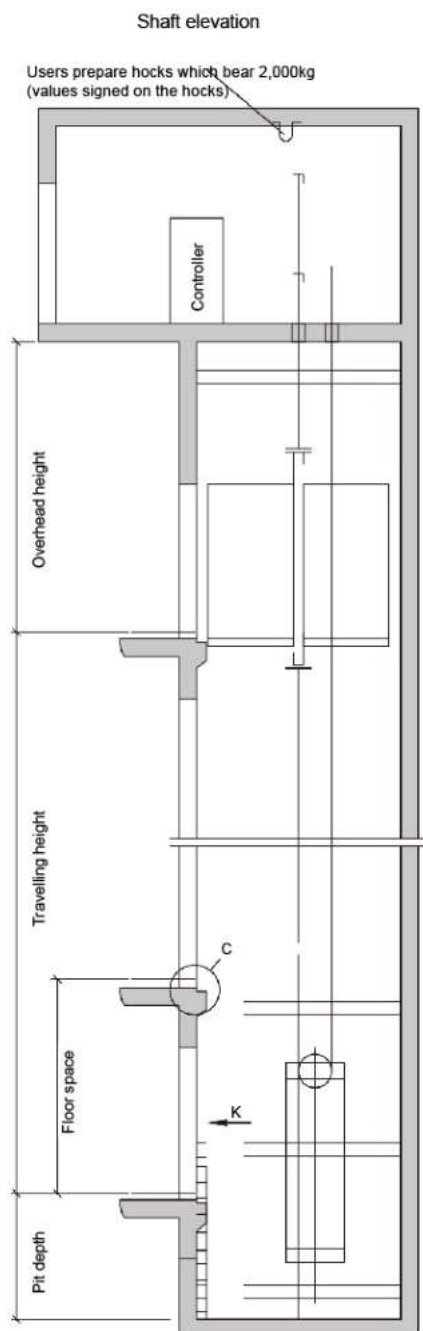

Hospital elevator parameter table

| Persons | Load (kg) | Speed (m/s) | Net size of car(mm) | Net size of door(mm) | Shaft size(mm) | | | Machine room size(mm) | |
|---------|--------------|----------------|---------------------|----------------------|----------------|------|------|-----------------------|------|
| | | | C.WxC.DxD.H | D.WxD.H | H.WxH.D | HR.H | PIT | MR.WxMR.D | MR.H |
| 21 | 1600 | 1.0 | 1400*2400*2300 | 1100*2100 | 2550*2900 | 4500 | 1500 | 2550*2900 | 2500 |
| | | 1.5/1.75 | | | | 4700 | 1600 | | |
| | | 2.0 | | | | 4900 | 1800 | | |
| | | 2.5 | | | | 5100 | 2000 | | |
| 24 | 1800 | 1.0 | 1600*2400*2300 | 1200*2100 | 2750*2900 | 4500 | 1500 | 2750*2900 | 2500 |
| | | 1.5/1.75 | | | | 4700 | 1600 | | |
| | | 2.0 | | | | 4900 | 1800 | | |
| | | 2.5 | | | | 5100 | 2000 | | |
| 26 | 2000 | 1.0 | 1700*2400*2300 | 1200*2100 | 2850*2900 | 4500 | 1500 | 2850*2900 | 2500 |
| | | 1.5/1.75 | | | | 4700 | 1600 | | |
| | | 2.0 | | | | 4900 | 1800 | | |
| | | 2.5 | | | | 5100 | 2000 | | |

HOME ELEVATOR



▼ Your Perfect Life is Comfortable and Relaxing

The humanization design decorates your noble life space. We enhance your life grade in the times of high & new tech. ALPHA home elevator brings about a more convenient and high-grade life.

It displays the outstanding properties in a limited space. It has no machine room. Extremely small top-floor height can match with various old and new residences. Relying on the standard track installation system, the elevator can be installed more quickly and conveniently. In addition, the smooth start and leveling system bring about the rare stable elevator operation.

Therefore you feel more comfortable in the elevator travel.

Home Elevator Construction Sketch

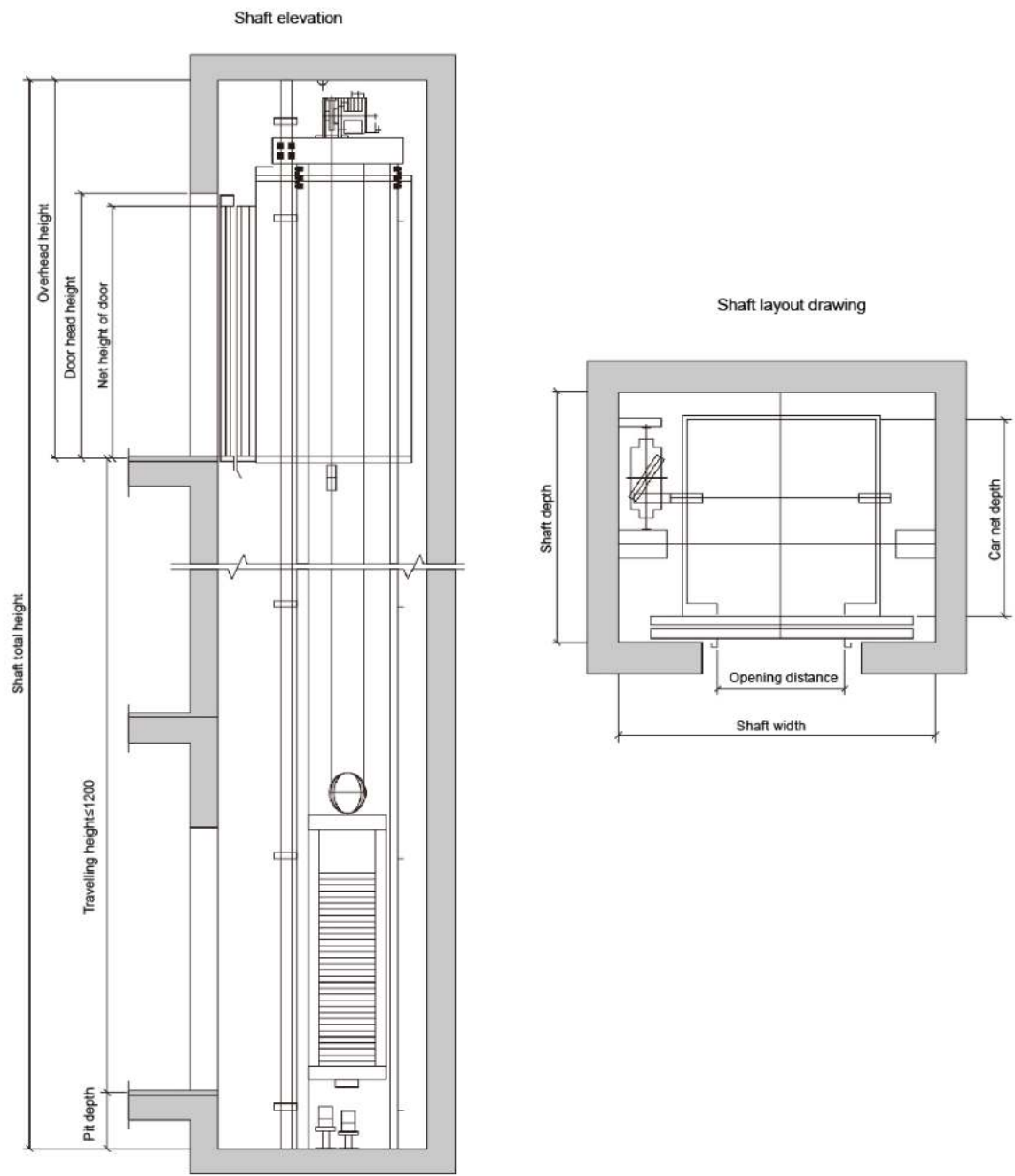

Home elevator parameter table

| Persons | Load (kg) | Speed (m/s) | Net size of car(mm) | Net size of door(mm) D.WxD.H | Shaft size(mm) | | |
|---------|--------------|----------------|---------------------|---------------------------------|----------------|------|-----|
| | | | C.WxC.DxD.H | 2P Central opening | H.WxH.D | HR.H | PIT |
| 3 | 260 | 0.4 | 800*1150*2200 | 700*2000 Side door | 1400*1500 | 3500 | 800 |
| 4 | 320 | 0.4 | 950*1300*2200 | 700*2000 | 1600*1600 | 3500 | 800 |
| 5 | 400 | 0.4 | 1200*1300*2200 | 800*2000 | 1850*1600 | 3500 | 800 |

FREIGHT ELEVATOR



▼ A loading giant that can release more and more cargo pressures for you

ALPHA freight lift serial fully utilizes the advanced and fully computerized contri technology. It employs the well-developed VVV Fcontrol system of ALPHA elevator. It is sample in structure and convenient in repair and maintenance. It fulfiles a qualitative leap in the aspects of the signal transmission and running control. It brings about the more stable ans reliable system, the lower noise, the smoother running, the more accurate leveling. It is more and more easy for the goods entry and exit. In addition, ALPHA freight lift serial can offer the micro-processor. The high speed running capabilities and expansion interface ensure to satisfy the special requirements from broad users.

▼ Light curtain protection

Several protective light curtains are formed at the entrance of the elevator, which sensibly detects and responses to any objects that intrude into the detecting scope. The safety of human and cargoes are guaranteed.

▼ The extremely humane operation

It is equipped with fully automatic collective selective function. It can fulfill operation with driver / without driver. The operation box specially and additionally sets door-shut delay" button in the operation box. Door-shut delay time can be flexibly adjusted at site according to the requirements. You feel more at case at loading and unloading the goods out of its humane setting.

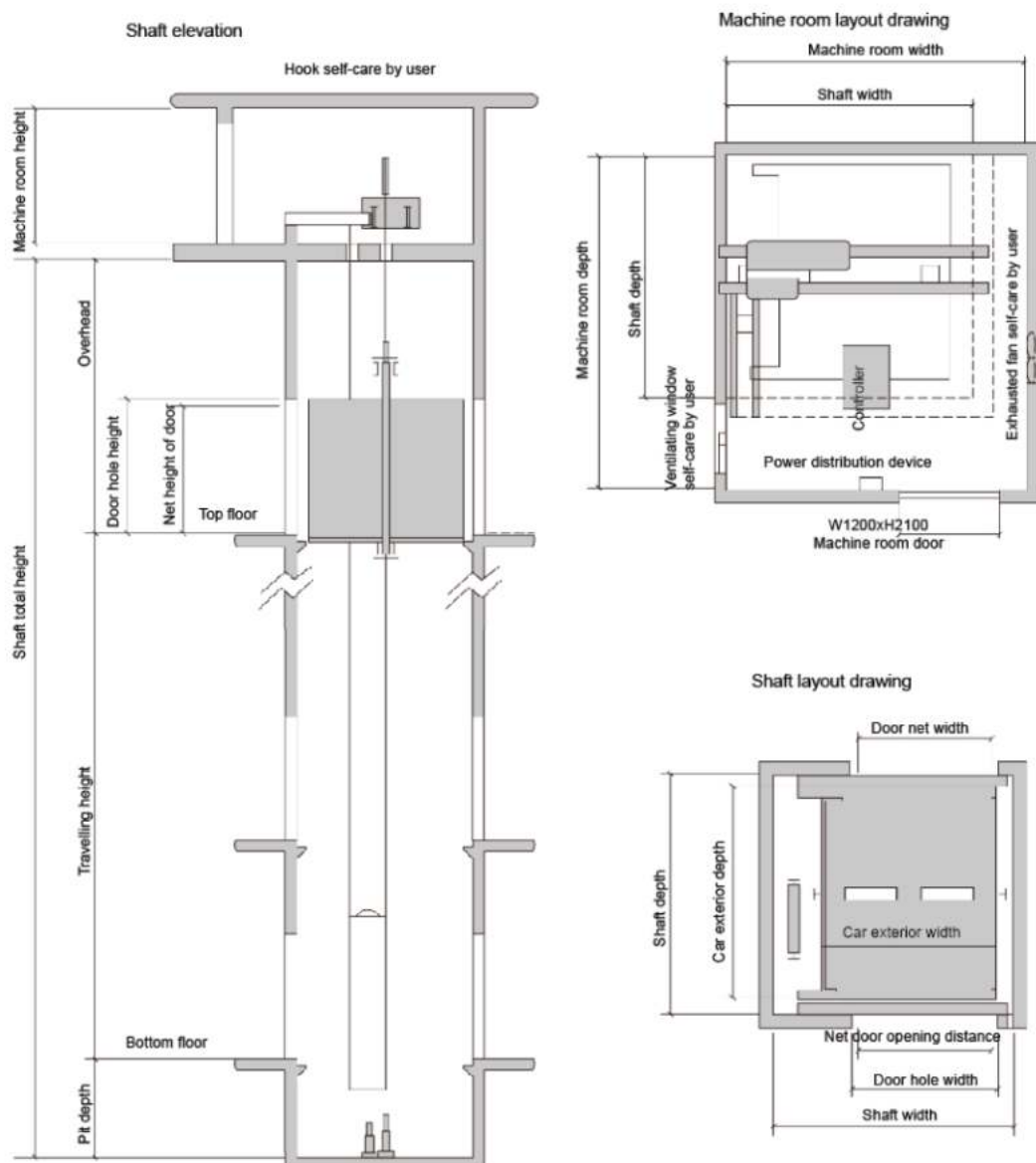

Freight elevator parameter table

| Load (kg) | Speed (m/s) | Net size of car(mm) | Net size of door(mm) | Shaft net size(mm) | | | Machine room net size(mm) | | Door open type |
|--------------|----------------|---------------------|----------------------|--------------------|--------------------|-----------|---------------------------|--------|------------------------------|
| | | C.Wx C.DxD.H | D.WxD.H | width x depth | Overhead height | Pit depth | width x depth | height | |
| 630 | 0.5 | 1200*1500*2200 | 1100*2100 | 2100*1860 | 4200 | 1500 | 2500*3000 | 2200 | Two panel side opening |
| 1000 | 0.5 | 1500*1800*2200 | 1200*2100 | 2250*2160 | 4200 | 1500 | 3000*3000 | 2200 | Two panel side opening |
| 2000 | 0.5 | 1570*2900*2200 | 1500*2100 | 2700*3260 | 4200 | 1500 | 3500*3000 | 2500 | Two panel side opening |
| | 1.0 | | | | 4500 | 1500 | | | Two panel side opening |
| | 1.5 | 2000*2300*2200 | | 2850*2660 | 4500 | 1600 | | | Four panel center opening |
| | 2.0 | | | | 4800 | 1800 | | | Four panel center opening |
| 3000 | 0.25 | 2070*3050*2200 | 1800*2100 | 3300*3410 | 4500 | 1500 | 3800*4200 | 2500 | Four panel center opening |
| | 0.5 | | | | | | | | Four panel center opening |
| 3200 | 1.0 | 2070*3100*2200 | 1800*2100 | 3300*3460 | 4500 | 1500 | 3800*4200 | 2500 | Four panel center opening |
| 5000 | 0.25 | 2800*3400*2500 | 2000*2200 | 4200*3800 | 5000 | 1600 | 4200*3800 | 2800 | Four panel center opening |
| | 0.5 | | | | | | | | Four panel center opening |
| 7000 | 0.25 | 3000*4200*2500 | 2600*2400 | 4500*4600 | 5000 | 1600 | 4500*4600 | 2800 | Four panel center opening |
| | 0.5 | | | | | | | | Four panel center opening |
| 10000 | 0.25 | 3070*5760*2500 | 2600*2400 | 4900*6200 | 5000 | 1600 | 4900*6200 | 2800 | Four panel center opening |

CAR ELEVATOR



✔ **Dual operation panels design (Optional)**

There are two operation box in the car. Therefore the driver can operate the elevator in the car without stepping out of it.



✔ **Special-purpose circuite control and display system**

Special circuit control and display system is convenient for the drivers inside/outside the car.



✔ **Front-and-rear opening elevator**

The elevator car sets front/rear door opening which is more convenient for the safety sector and for the cars to enter into/exit the elevator cars.

Car Elevator Construction Sketch

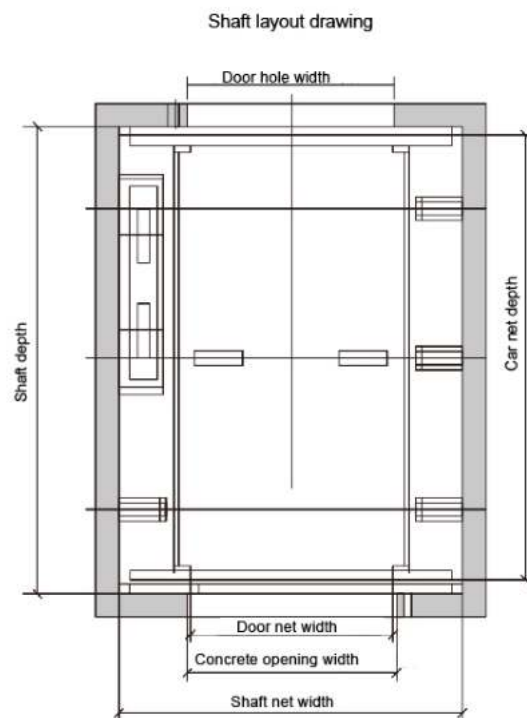
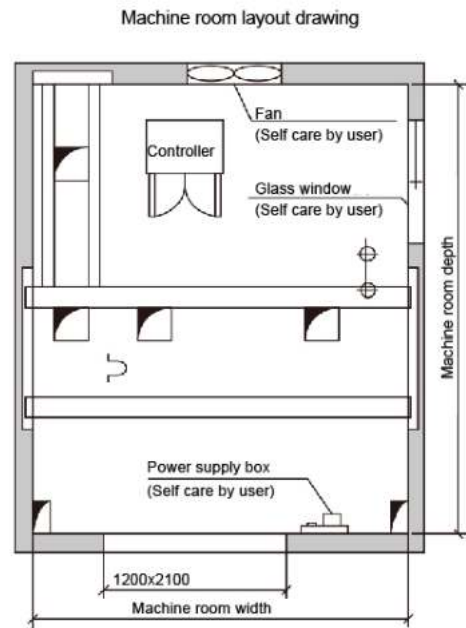
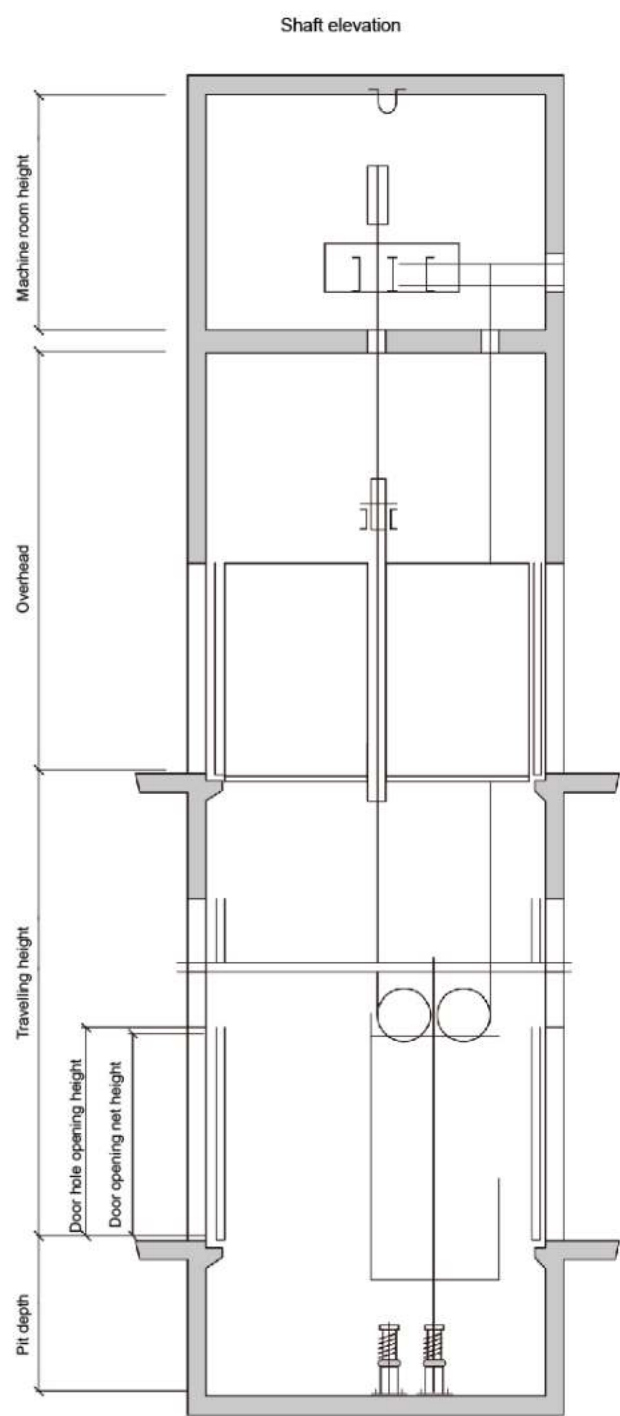

Car elevator parameter table

| Load (kg) | Speed (m/s) | Door open type | Net door opening widthxheight(mm) | Exterior size of car widthxdepth(mm) | Shaft net size(mm) | | | Machine room net size(mm) widthxdepthxheight |
|--------------|----------------|---------------------------|--------------------------------------|--|--------------------|-----------|-----------------|--|
| | | | | | widthxdepth | pit depth | overhead height | |
| 3000 | 0.25/0.5 | Four Panel Center Opening | 2400*2200 | 2700*5800 | 4100*6160 | 1600 | 4800 | 4100*6160*2500 |
| 5000 | 0.25 0.5 | Four Panel Center Opening | 2600*2200 | 3500*7200 | 4750*7560 | | | 4750*7560*2500 |

ESCALATOR



Traffic Solution Plan Specialist

It Innovatively combines with human-centered ideas. It has the advanced stairway and belt design.

It is smooth and comfortable in operation. Solemn and smooth handrail entry, traffic flow light appear bright and dynamic. It perfectly connects with inner/outer cover plates, skirting plate, frontline plate. It smoothly transits to big arc rotary end handrail.

ALPHA escalators are widely applicable for the airport, railway station, high grade hotel, CBD, large-size shopping center, public facilities etc. It adds a brilliant sight line for modern building.

■ Its truss adapt the superior profile steel with unique structure, high intensity, through anti-rusting, good effect, long life.

■ The advanced international manufacture craft, technology, general assembly, tooling guarantee the precise elevator path.

■ Super-strong CPU master-board computer control executes real-time monitor to the running conditions. It automatically stops at any abnormal conditions. It also promptly and automatically makes records, displays the trouble code.

35° ESCALATOR CONSTRUCTION SKETCH

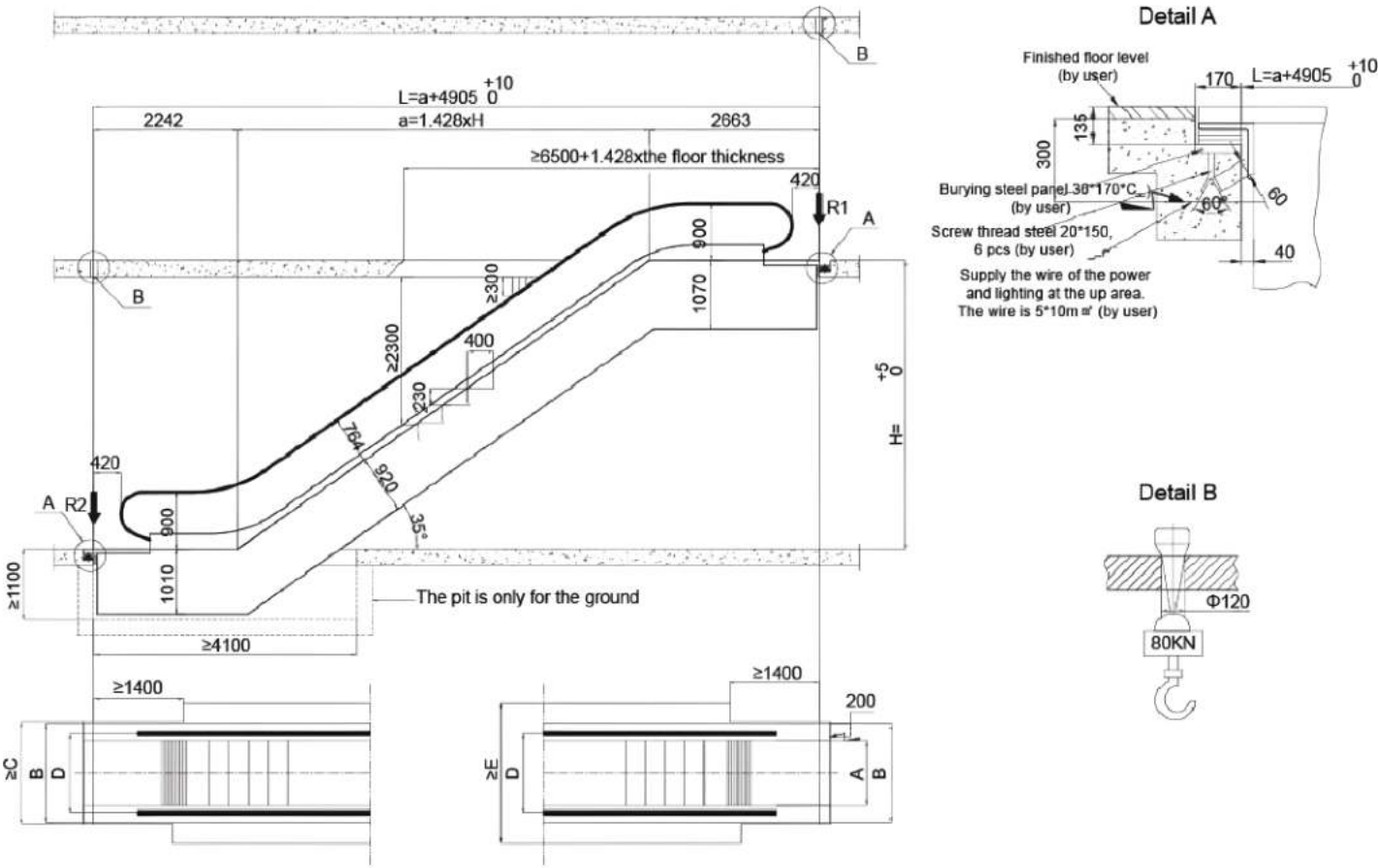

Reacting force

| Step width | 600 | 800 | 1000 | Remark |
|------------|------------|--------|------------|--------|
| R1(KN) | 3.5xL+15.5 | 4xL+17 | 4.5xL+18.5 | L=m |
| R2(KN) | 3.5xL+10 | 4xL+11 | 4.5xL+11.5 | |

Power meter(Step width 1000mm speed 0.5m/s)

| 5.5KW | 8KW | 11KW |
|-------------|-------------|-------------|
| 1.5m≤H≤3.5m | 3.5m<H≤5.0m | 5.0m<H≤6.0m |

Table of rules of extension interior escalator's upper part

| | Power | | | | |
|--------------|------------|-------|------|--------|--------|
| | Step width | <15KW | 15KW | 2X11KW | 2X15KW |
| Without VVVF | 600 | 417 | 417 | | |
| | 800 | 0 | 0 | 500 | |
| | 1000 | 0 | 0 | 500 | 800 |
| With VVVF | 600 | 417 | 417 | | |
| | 800 | 0 | 200 | 500 | |
| | 1000 | 0 | 0 | 500 | 800 |

Standard specification and dimension



| Model | | SN-ES-600 | SN-ES-800 | SN-ES-1000 |
|-------------------------|---|-----------|-----------|------------|
| Step width | A | 600 | 800 | 1000 |
| Decorating width | B | 1140 | 1340 | 1540 |
| Construction open width | C | 1200 | 1400 | 1600 |
| Space between handrail | D | 838 | 1038 | 1238 |
| Construction open width | E | 1778 | 1978 | 2178 |

| Notes | | | | Specification parameter | |
|---|-----------------|---------------------------|--|-------------------------|--|
| <p>*The layout drawing is suitable for the construction which the height is below 6m.</p> <p>*If the step width is 600mm, 417mm shall be extended at the up of the truss.</p> | | Type | | SN-ES-600-35 | |
| | | | | SN-ES-800-35 | |
| | | | | SN-ES-1000-35 | |
| | | | | | |
| | | Speed | | 0.5m/s | |
| | | Rise height | | H≤6000mm | |
| | | Angle | | 35° | |
| | | Supporting R1 | | KN | |
| | | Supporting R2 | | KN | |
| | | Weight W | | KN | |
| Power | Power supply | Three-phase AC 380V 50HZ | | | |
| | Lighting supply | Single-phase AC 220V 50HZ | | | |





PERFECT FUNCTION

★ Standard Function

| | | |
|--|---|---|
|  Travel Function | VVVF drive | Motor rotating speed can be precisely adjusted to get smooth speed curve in lift start, travel and stop and gain the sound comfort. |
| | VVVF door operate | Motor rotating speed can be precisely adjusted to get the more gentle and sensitive door machine start/stop. |
| | Independent running | The lift can not respond to outer calling, but only respond to the command inside the car through the action switch. |
| | Automatic pass without stop | When the car is crowded with the passengers or the load is otiose to ppreset value, the car will automatically pass the calling landing in order to keep maximum travel efficiency. |
| | Automatically adjust door opening time | Door-open time can automatically adjusted according to the difference between landing calling or car calling |
| | Reopen with hall call | In the door shutting process, press reopen with hall callbutton can restart the door. |
| | Express door closing | When the lift stops and opens the door, press door-shut button, the door will be closed immedeiatly. |
| | Car stops and door open | The lift decelerates and levels, the door only opens after the lift comes to a complete stop. |
| | Command register cancel | If you press the wrong floor command button in the car,twice continuous pressing of same button can cancel the register. |
|  Safety Function | Photocell protection | In the door open and shut period, infrared light that covers the whole door height is used to probe the door protection device of both the passengers and objects. |
| | Designated stop | If the lift can not open the door in the destination floor out of some reason, the lift will close the door and travel to the next designated floor. |
| | Overload holding stop | When the car is overload, the buzzer rings and stops the lift in the same floor. |
| | Anti-stall timer protection | The lift slops operation due to slippery traction wire rope. |
| | Start protection control | If the lift does not leave door zone within the designated time after it gets started, it will stop the operation. |
| | Inspection operation | When the lift enters into inspection operation, the car travels at inching running. |
| | Fault self-diagnosis | The controller can record 62 latest troubles so as to quickly remove the trouble and restore the lift operation. |
| | Repeated door closing | If the lift can not close the door due to certain obstacle or interference, the lift will reopen, or re-shut the door until sundries are eliminated. |
| | Up/down aver-run and final limit protection | The device can effectively prevent from the lift's surging to the top or knocking the bottom when it is out of the control.It results in the more safe and reliable lift travel. |
| | Down over-speed protection device | When the elevator downs1.2 times higher than the rated speed. This device will automatically cut off control power. stop the motor running so as to stop lift down at over-speed. If the lift continues to down at over-speed, and the speed is 1.4 times higher than rated speed, safety tongs act to force the lift stop in order to ensure the safety. |
| | Upward over-speed protection device | When the lift ups 1.2 times higher than rated speed,the device will automatically decelerate to brake the lift. |
|  Man-machine Interface | Micro-touch button for car call and hall call | Novel micro-touch button is used for operation panel command button in the car and landing calling button. |
| | Floor and direction indicator car | The car shows the lift floor location and current travel direction. |
| | Floor and direction indicator | The landing panel shows the lift floor location and current travel direction. |

| | | |
|---|---|--|
|  Emergency Function | Emergency car lighting | Emergency car lighting automatically activated when there is power failure. |
| | Inching running | When the elevator enters into emergency electric operation, the car travels at low speed inching running. |
| | Five way intercom | Communication amid car, car top, elevator machine room, well pit and rescue duty room through walkie-talkie. |
| | Bell | In emergency conditions, if bell button above car operation panel is continuously pressed, electric bell rings on top of the car. |
| | Fire emergency return | If you start key switch in main landing or monitor screen, all the callings will be cancelled. The elevator directly and immediately drives to the designated rescue landing and automatically opens the door. |
|  Energy-saving Function | Car ventilation, light automatic shut off | If there is no calling or command signal within the stipulated time, the car fan and lighting will be automatically closed in order to save the energy. |
| | Remote shut-off | The elevator can be called to main landing (after finishing the service) through the key switch and automatically exists the service. |

★ Optional Function

| | | |
|--|-----------------------------------|--|
|  Emergency Function | Leveling when power failure | In normal power failure, the chargeable battery supplies the elevator to power. The elevator drives to the nearest landing. |
|  Travel Function | Anti-nuisance | In the light elevator load, when three more commands appear, in order to avoid the unnecessary parking, all the registered callings in the car will be cancelled. |
| | Open the door in advance | When the elevator decelerates and enters into door open zone, it automatically opens the door to enhance the travel efficiency. |
| | Direct parking | It completely accords with distance principle with no crawling in the leveling. It greatly enhances the travel efficiency. |
| | Group control function | When three or more same model lift groups are controlled in use, the lift group can automatically choose the most appropriate response. It avoids the repeated lift parking, reduces the passengers' waiting time and increases the travel efficiency. |
| | Duplex control | Two sets of same model elevators can unanimously respond the calling signal through the computer dispatch. In this way, it reduces the passengers' waiting time to the greatest extent and enhances the travel efficiency as well. |
| | On-duty peak service | Within the preset on-duty time, upward transport from the home landing is extremely busy. The lifts are continuously dispatched to the home landing in order to satisfy on-duty peak service. |
| | Off-duty peak service | Within the preset off-duty period, the lifts are continuously dispatched to top floor in order to satisfy off-duty peak service. |
| | Door open time extending | Press special button in the car, the lift door keeps open for certain period of time. |
| | Car arrival gong | Arrival long in the car top announces that the passengers arrive. |
|  Man-machine Interface | Voice announcer | When the elevator normally arrives, voice announcer informs the passengers about the relevant information. |
| | Car assistant operation box | It is used in the large loading weight lifts or the elevators with crowded passengers so that more and more passengers can use the car. |
| | Operation box for the handicapped | It is convenient for the wheelchair passengers and those who have vision problems. |
| | Intelligent calling service | The car command or hoist-way calling can be locked or connected through special Intelligent Input. |
| | IC card control function | All(partial) landings can only input car commands through IC card after authorization. |
|  Monitor Function | Remote monitor | The elevator long-distance monitor and control can be fulfilled through modem and telephone. It is convenient for the factories and service units to timely know the travel conditions of every elevator and promptly take the corresponding measures. |
| | Remote control | The life car have independent travel according to the specific requirements through operation monitor screen(optional). |
| | Camera function in the car | The camera is installed in the car to monitor the car conditions. |

CABIN DECORATION

Modern Series



Alpha -129



Alpha -131



Alpha -142



Alpha -146



Alpha -150



Alpha -155



Alpha -164



Alpha -168



Alpha -303

CABIN DECORATION

Modern Series



Alpha -153



Alpha -429



Alpha -432



Alpha -433



Alpha -434



Alpha -435



Alpha -436



Alpha -106



Alpha -107

CABIN DECORATION

Luxury Series



Alpha - 434



Alpha - 435



Alpha - 436



Alpha - 438

CABIN DECORATION

Luxury Series



Alpha - 437



Alpha - 439



Alpha - 451



Alpha - 453

CABIN DECORATION

Luxury Series

Adrina



Sultan



Merlot



Arma

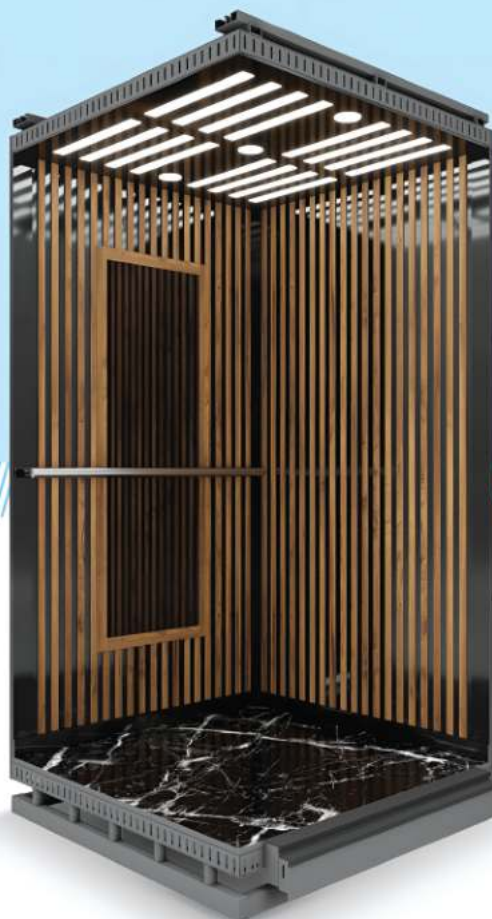

CABIN DECORATION

Luxury Series



Brando



Patria



Bandera



Pulsar

CABIN DECORATION

Luxury Series



Alpha - 455



Alpha - 456



Alpha - 457



Alpha - 458

OPERATION PANEL



▶ Optional display



▶ Optional button



▶ Direction lantern

OPERATION PANEL



Economic Solution

Modern Solution

Luxury Solution

OPERATION PANEL



7325.M7VT



9315.DS2X



C.FSBG
9315.DS2X



7215.DS2X



7215.DS2X



2002



30W0



1012



2012



AVAC-1002



AVAC-1002



AVAC-1012



AVAC-2072



4210



AVAC-4210

ELEVATOR CEILING SERIES

Standard Solution



Alpha - 501

White arch light-emitting panel, stainless steel mirror frame, strip light decoration



Alpha - 502

Titanium gold stainless steel mirror base-plate is supplemented with rectangle hollow transparent light pole, central soft lighting design of white organic panel

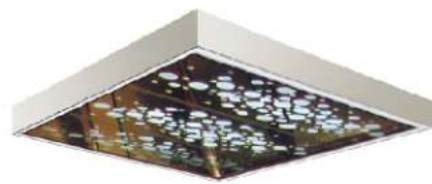

Alpha - 503

Stainless steel mirror hollow panel, white organic panel, mirror stainless steel frame



Alpha - 504

Stainless steel titanium gold mirror hollow panel, white light-emitting panel, mirror stainless steel frame



Alpha - 505

Stainless steel mirror hollow panel, white organic panel, mirror stainless steel frame



Alpha - 506

Stainless steel mirror hollow panel, white organic panel, aluminum alloy frame



Alpha - 507

Stainless steel mirror hollow panel, white organic panel, aluminum alloy frame



Alpha - 508

Mirror stainless steel panel is supplemented with rectangle hollow transparent light pole, central soft lighting design of white organic light-emitting panel



Alpha - 510

Central image arch, two-side stainless steel base-plate is supplemented with soft lighting design of down lamp (image to be provided by client)

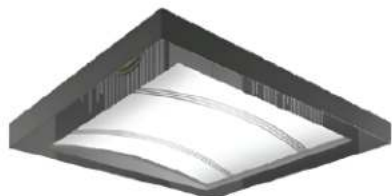

Alpha - 511

Soft lighting design of broad arch white light-emitting panel



Alpha - 515

Central image arch, two-side stainless steel base plate, soft lighting design of down lamp



Alpha - 518

Soft lighting design of broad image arch

ELEVATOR CEILING SERIES

Standard Solution



Alpha - 519

Round art panel model, rear soft lighting design of down lamp



Alpha - 520

Round steel bar model, white organic panel, rear soft lighting design of down lamp



Alpha - 521

Round hollow art panel model, rear soft lighting design of down lamp



Alpha - 522

Round glass model, rear soft lighting design of down lamp



Alpha - 523

Round lotus pattern art panel, rear soft lighting design of down lamp



Alpha - 524

Central white ceiling lamp, four-side stainless steel base plate with soft lighting design of down lamp

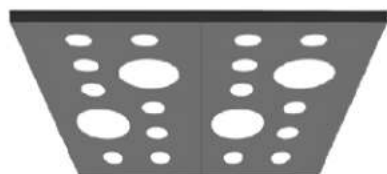

Alpha - 527

Stainless steel frame, white acrylic light-emitting

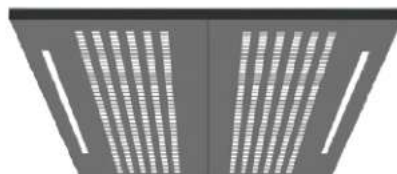

Alpha - 528

Stainless steel square tube frame, mirror stainless steel, down light



Alpha - 529

Stainless steel side frame + soft lighting design of arch white light-emitting panel



Alpha - 530

Stainless steel side frame + soft lighting design of arch white light-emitting panel



Alpha - 531

Stainless steel square tube frame, mirror stainless steel, down light



Alpha - 532

Stainless steel side frame + soft lighting design of arch white light-emitting panel

ELEVATOR PANEL SERIES

Standard Solution



Alpha - 301
Mirror,Hairline,Etched



Alpha - 302
Mirror,Etched



Alpha - 334
Mirror,Etching,Concave Golden



Alpha - 337
Mirror,Etching,Golden,Hairline



Alpha - 356
Mirror,Etching,Hairline



Alpha - 363
Mirror,Etching,Hairline,Concave Golden



Alpha - 427
Titanium,Mirror,Etching



Alpha - 321
Mirror,Hairline



Alpha - 322
Mirror,Etched

ELEVATOR PANEL SERIES

Standard Solution



Alpha - 343
Mirror, Etched, Hairline



Alpha - 347
Mirror, Etched, Hairline



Alpha - 348
Mirror, Etched



Alpha - 323
Mirror, Etched, Rose gold



Alpha - 336
Mirror, Etched, Titanium Golden



Alpha - 339
Mirror, Etched



Alpha - 388
Mirror, Etching, Titanium Golden



Alpha - 395
Mirror, Etching, Titanium Golden



Alpha - 396
Mirror, Hairline, Titanium Golden

ELEVATOR PANEL SERIES



2 PANEL DOOR

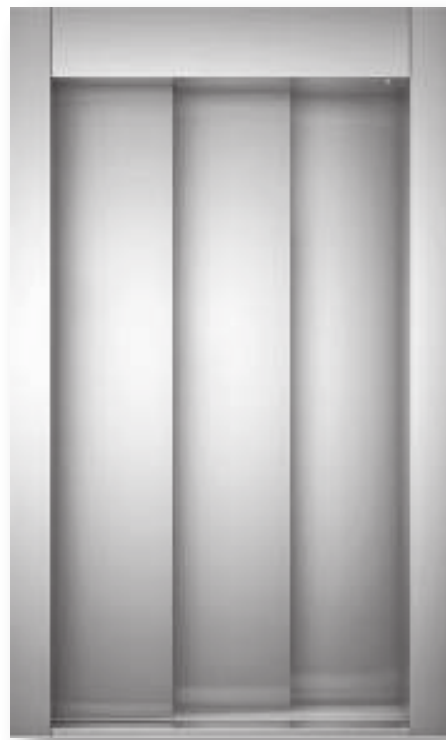

3 PANEL DOOR



4 PANEL DOOR



6 PANEL DOOR

ELEVATOR FLOOR PANEL



Alpha - 601



Alpha - 602

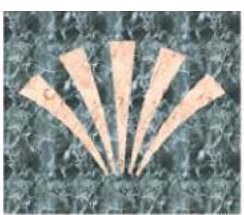

Alpha - 603

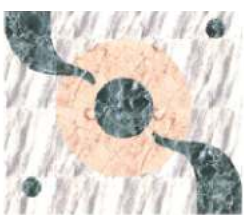

Alpha - 604



Alpha - 605



Alpha - 606

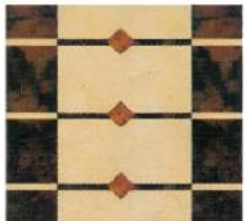

Alpha - 615



Alpha - 616



Alpha - 620



Alpha - 621



Alpha - 609



Alpha - 610

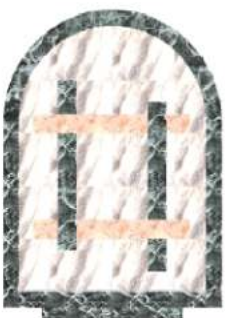

Alpha - 613



Alpha - 614

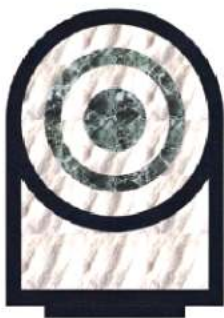

Alpha - 696

OPTIONAL COLORS



Alpha -7047



Alpha -7040



Alpha -1015



Alpha -7032



Alpha -5002



Alpha -5024



Alpha -6021



Alpha -3015

LAMINATES



Boa Vista Teak



Yukon Oak



Mont Pelvoux Oak



Rhodes Teak



Cashel Oak



Orleans Oak



Ketchikan Oak



Banff Walnut



Kinsale Oak 4



Annapurna Teak



Caucasian Walnut



Mendoza Oak

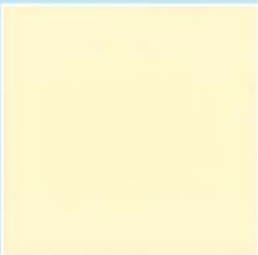

8001



8002



8003



8004



8005



8006



8006



8006

ELEVATOR HANDRAIL



ELEVATOR DOOR OPERATOR

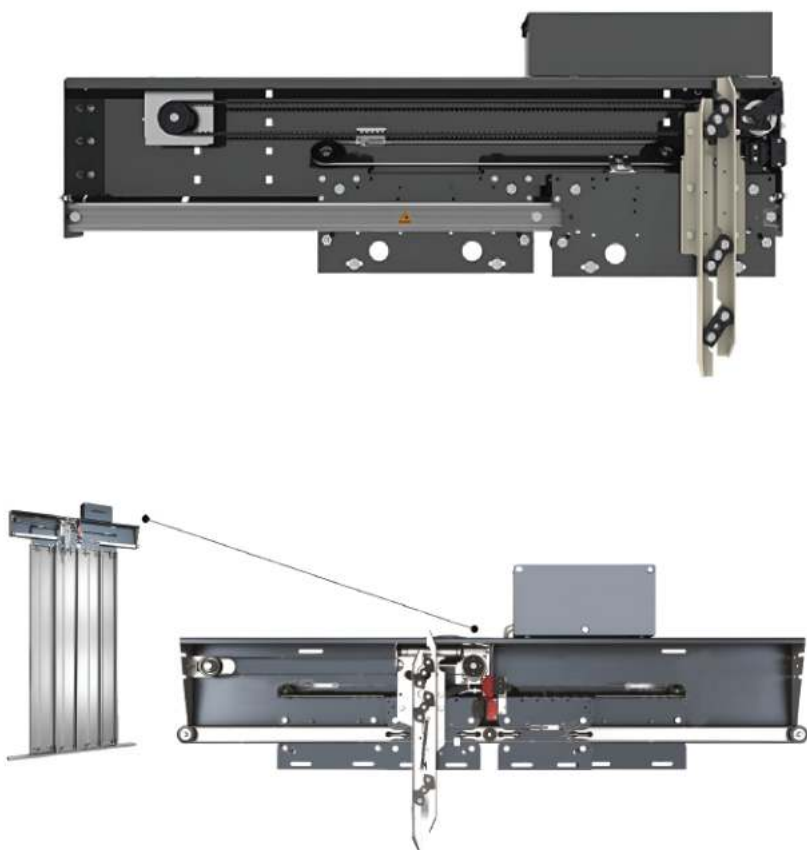

TRACTION MOTORS



AKIŞ (VOLPI)



AKIŞ



AKAR



AKAR



ALBERTO SASSI



ALBERTO SASSI



SICOR



SICOR

TRACTION MOTORS



CONTROL PANEL



NICE1000+



NICE3000+



NICE900



AS320



AS330



AS360



AS380



INV-SP5000



INV-SP3000



INV-SP9000

ABOUT US

Alpha Elevator & Engineering Ltd. is a sister concern of HCPL (Hossain Construction Pvt. Ltd.), a trusted name in construction and engineering with a legacy of excellence. As a premier provider of vertical transportation solutions in Bangladesh, we take pride in delivering high-quality, innovative, and reliable elevator systems tailored to the diverse needs of our clients. Our elevator brand, Alpha, embodies our unwavering commitment to superior craftsmanship, cutting-edge technology, and exceptional customer service. With a strong foundation in engineering expertise and a customer-centric approach, we strive to enhance the safety, efficiency, and convenience of vertical mobility in residential, commercial, and industrial spaces. Our dedication to quality, sustainability, and continuous improvement ensures that Alpha remains a benchmark

MANAGING DIRECTOR'S MESSAGE

At Alpha Elevator & Engineering Ltd., we are steadfast in our commitment to solidarity, mutual success, societal contribution, and the well-being of our employees. Guided by these principles, we have forged a path of comprehensive growth built on a foundation of integrity, credibility, and professionalism. Reflecting on the challenges and triumphs of our journey thus far, we take pride in the dedication that drives our present and fuels our aspirations for the future. It is this spirit of collaboration and innovation that has propelled Alpha Elevator to its current success. The road ahead is filled with promise and opportunities. Together, let us join hands to achieve shared prosperity and craft a brighter, more prosperous future.



Md. Anwar Hossain
Managing Director

BRAND COMPETITIVENESS

Alpha Elevator: Leading Through Innovation, Quality & Service

Alpha Elevator has established a strong market presence through its commitment to quality, innovation, and customer satisfaction. Continuously enhancing brand competitiveness, the company reinforces its core values while driving industry leadership.

▼ Technical Excellence

- **Energy-Efficient Solutions:** Cutting-edge technology minimizes environmental impact and operational costs.
- **Smart Management:** Intelligent systems enhance efficiency, performance, and user experience.
- **Advanced Safety:** Industry-leading safety features ensure passenger protection.

▼ Strong Market Presence

- **Trusted Brand:** Built on quality and excellence.
- **Expanding Reach:** A robust global network supports consistent growth.

▼ Exceptional Service

- **User-Centric Approach:** Seamless support from pre-sales to after-sales.
- **Rapid Response:** Quick solutions tailored to customer needs.
- **Reliable Support:** Strong technical backup and ample spare parts ensure long-term dependability.

By leveraging innovation, expanding its market, and delivering superior service, Alpha Elevator continues to set new industry standards.



Bangladesh Address:

Phone: +8801874067779 / +8801874067780

Address: Alpha Elevator & Engineering Ltd.

HCPL Tower, Commercial Plot No # 16, Main Road # 1,
Section # 10, Senpara Parbata, Kafrul, Dhaka-1216,
Bangladesh.

China Address:

Phone: +8619864970216

Address: Room # 6905, 69/F, Saige Square, Huaqiang
North Road, Futian District, Shenzhen City. Guangdong
Province,
China.